

FUTURE

Tomorrow starts Today

Dubai Expo's Heartbeat

Connecting Minds, Creating the Future.

CASE STUDY

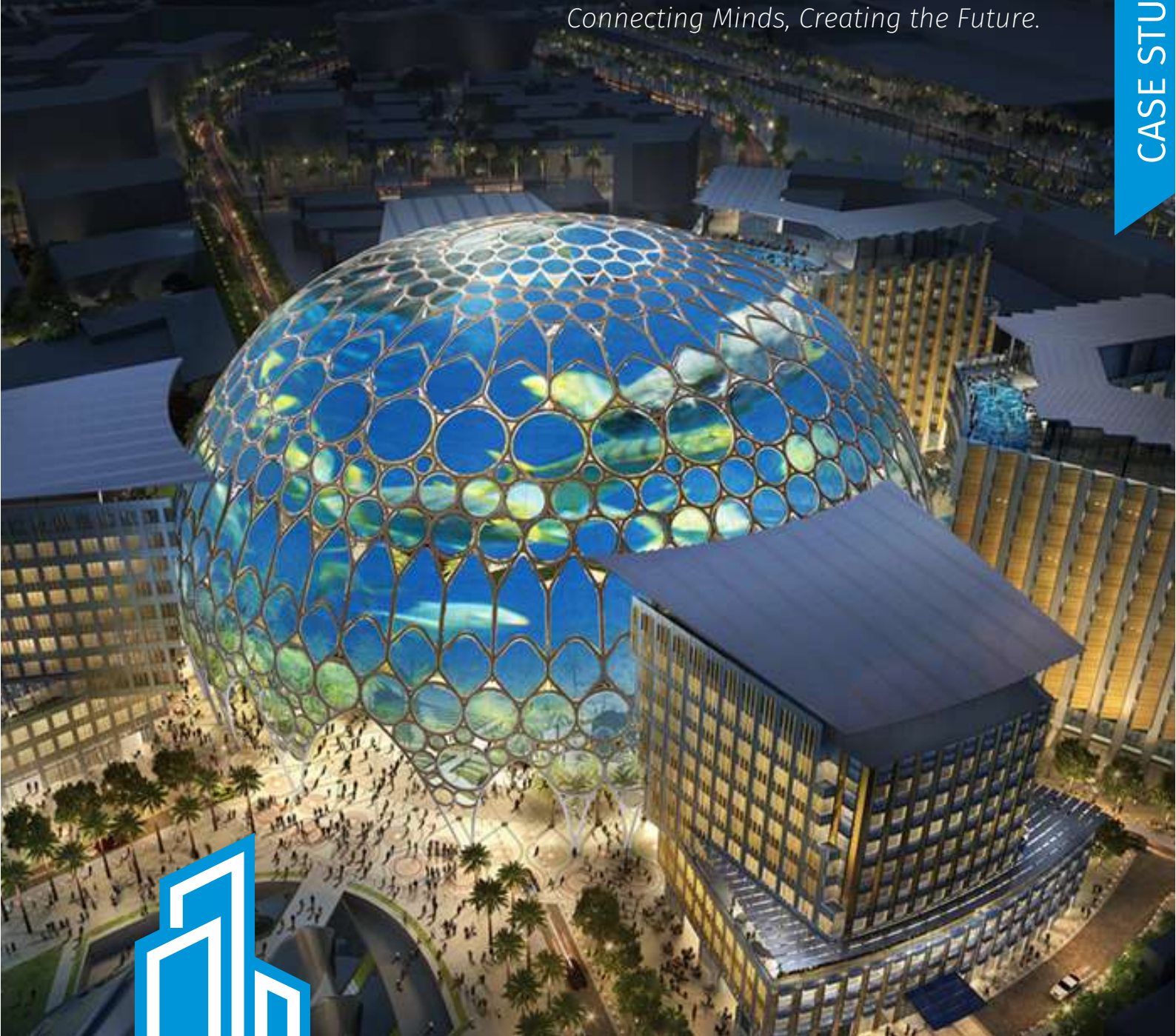

FACADES

Al Wasl Plaza

www.faglass.com

ABOUT THE PROJECT

Al Wasl Plaza was the heart of Dubai Expo 2020 and continues to remain the focal point of Expo City. The central dome, surrounded by a decorative garden and five buildings, truly reflects the theme, Connecting Minds, Creating the Future. Working on the Al Wasl Plaza required careful thought and consideration. We had to ensure that the three office buildings and two hotels enjoyed unobstructed views of the garden and dome while maintaining energy efficiency and privacy.

The project was designed by Chicago-based architecture firm Adrian Smith + Gordon Gill. Since the project was part of Expo 2020, which invited representatives from around the globe, we had to ensure we met and exceeded global glass and glazing standards. We understood that the buildings were the supporting cast for the dome and gardens, yet they played a crucial role in making the entire plaza the focal point of the Expo.

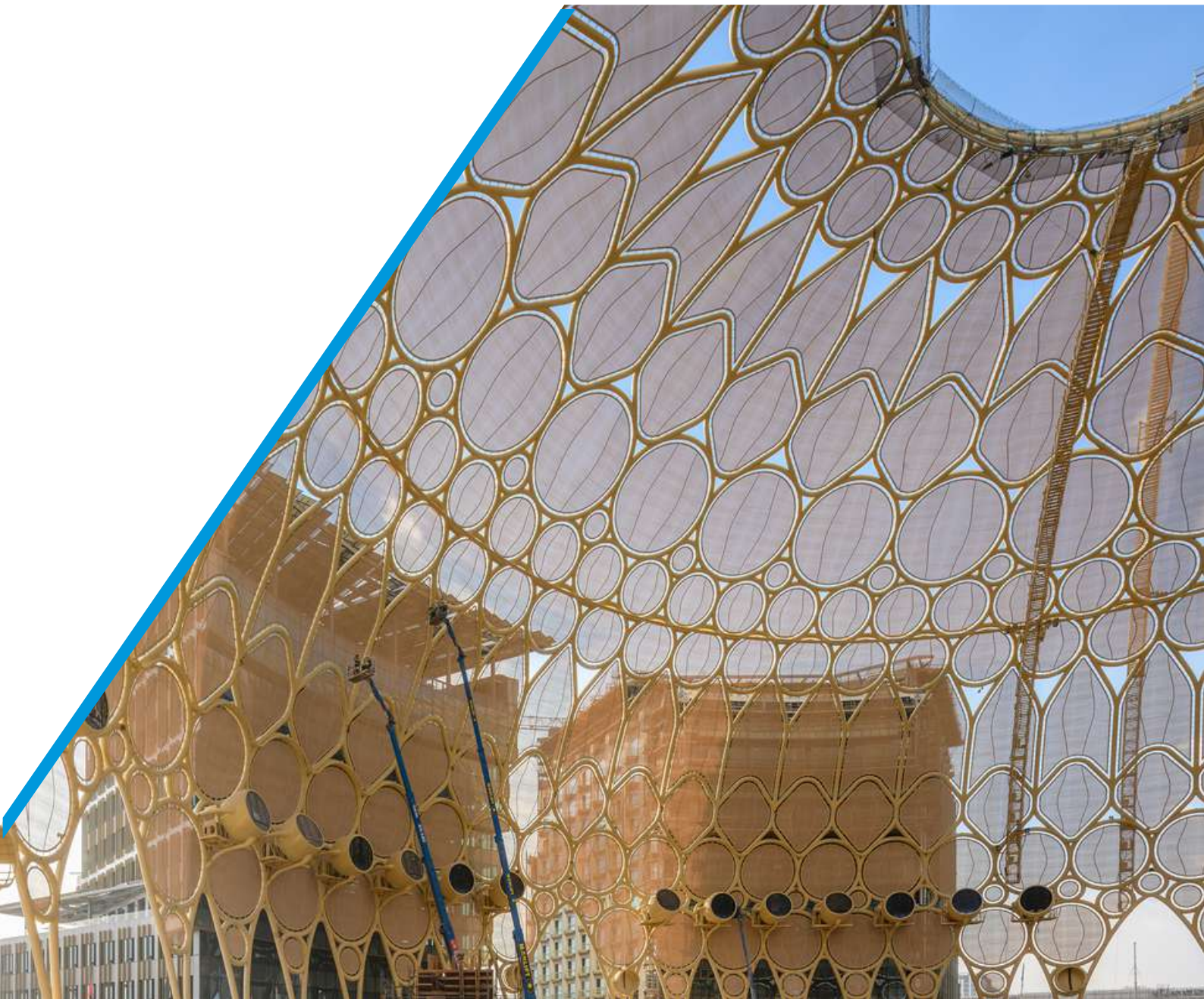



KEY FACTS ABOUT THE PROJECT

The architects of the square, Adrian Smith + Gordon Gill, are known for designing and developing energy-efficient and sustainable properties. Our main objective was to help create an active and living public space that became the benchmark for energy, carbon and economic sustainability. Our job was to ensure that the buildings added to the overall appeal of the plaza and provided unhindered views without impacting performance or privacy. After careful consideration, we decided that Guardian coated glass would be the ideal option for the project. To ensure the glazing offered unhindered views, we relied on our state-of-the-art processing centre to monitor the optical clarity and record the individual department parameters at each production stage.

Our furnace is equipped with a real-time optical scanner, Litesentry Osprey, that checks the topology of each panel as it exits the quenching chamber. The scanner checked for roller waves and edge dips to ensure compliance with the stringent optical parameters set for the project or <0.076 mm for roller wave and <0.20 mm for edge dip. Panels that did not meet the set standard got rejected. By following stringent checks at every stage, we completed the project on time without on-site rejections. The office and hotel buildings of Al Wasl Plaza continue to offer unparalleled views of the dome and gardens that are still active concert venues.

- Supply Year: 2020
 - Façade Contractor: JML
 - Design Architect: Adrian Smith + Gordon Gill
 - Main Contractor: Al Shafar
- Glass: Guardian Sunguard SN40 & SN70 coated glass





FUTURE

Future Glass General Trading LLC

2411 Churchill Executive Tower, Business Bay, PO Box 117259, Dubai

☎ +971 50 747 5473 | ✉ sales@faglass.com

WORK

P278 Al Ghail Industrial Area, Ras Al Khaimah (UAE), PO Box 86001

☎ +971 7 258 9274 | 📠 +971 7 258 9071

www.faglass.com



  /faglassllc